

## DEAR READERS,

six months have gone by since we released our first ELI Project Newsletter and this second issue is the opportunity to report and inform you on significant progress achieved in the meantime.

In November 2009, the grant application for funding ELI was submitted to the Structural Funds Managing Authority of the Ministry of Education, Youth and Sports. ELI's funding request successfully passed national and international evaluation panels and has been very recently sent to the European Commission for a final evaluation. The Commission's decision likely to be announced by the end of 2010. Once we will hopefully get the go-ahead from Brus-

sels, procurement procedures for the construction of the building itself and for the development of technologies will start along with all other steps necessary for ELI's successful implementation.

In the meantime, however, the needs of the project leave no time for rest to the team and, as this newsletter shows, a lot already has to be undertaken to ensure that the Czech Republic, in a few years from now, will be able to take pride in a best-of-class research infrastructure. See by yourself...

In the name of the entire ELI team in the Czech Republic

**Jan Řídký**

*Director of the Institute of Physics AS CR*



# ARCHITECTONICAL DESIGN OF ELI



The ELI Beamlines Project received zoning permit with legal validity in January 2010. We are now working hard on the documentation for building permit.

A wooden model of the ELI building was created. It is exhibited in the entrance hall of the Institute of Physics in Prague.



## ELI RESEARCH ACTIVITIES

The ELI Beamlines Facility will be dedicated to the generation of ultraintense secondary sources for interdisciplinary applications in Physics, Chemistry, Medicine, Biology and Material Engineering among others.

The backbone of this infrastructure will be a laser system, which will become one of the most powerful in the world.

The facility will serve a large variety of research, application and development projects based on the interaction of ultraintense laser pulses with matter.

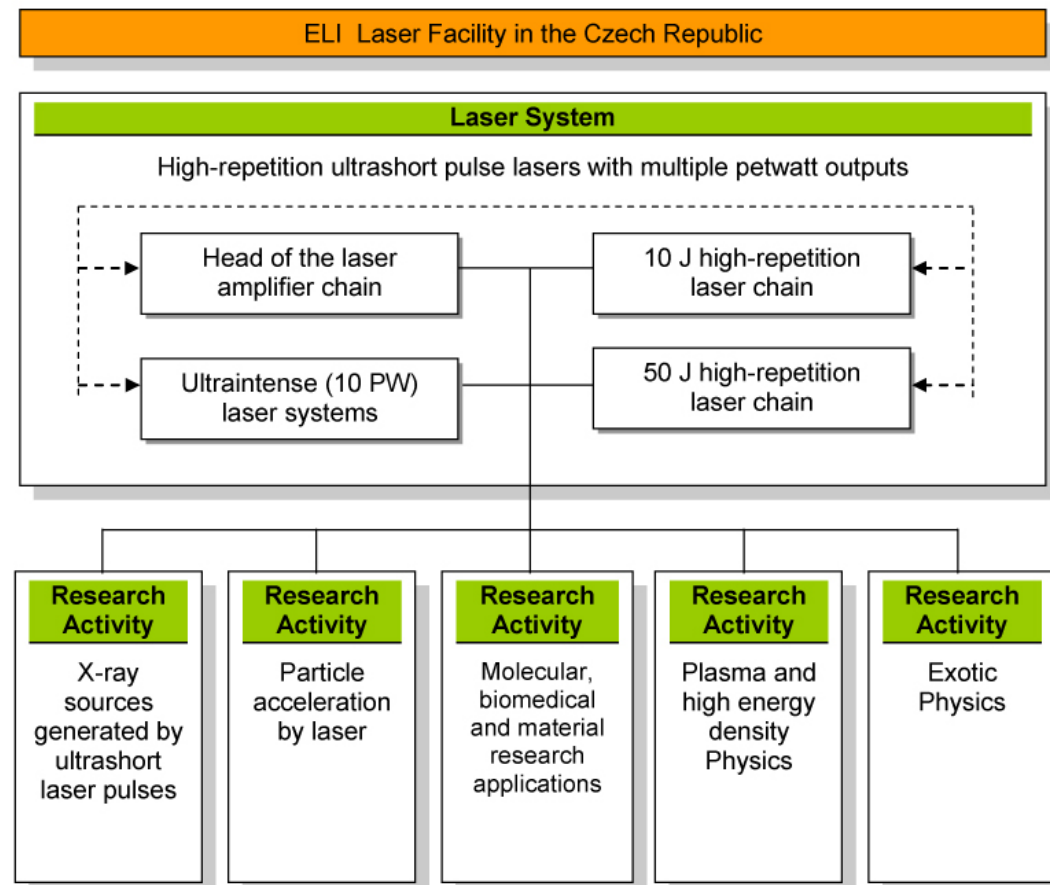
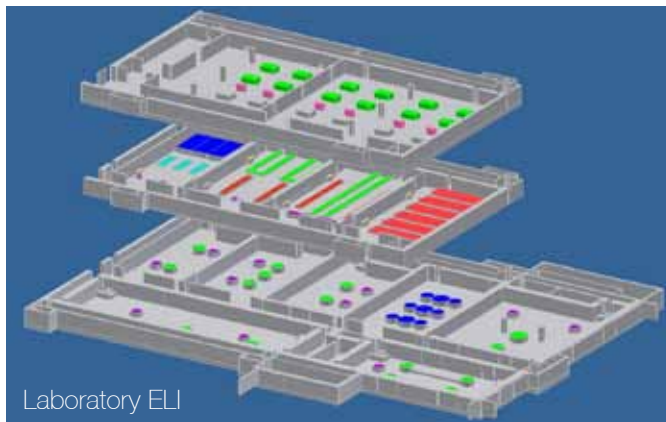

## NATIONAL AND INTERNATIONAL EVENTS

### PRESENTATION AT TIC ČKS INCUBATOR



On 1 April 2010 the Institute of Physics and the Technology Centre of the Academy of Sciences organized a seminar and meeting of companies on the topic "Possible Cooperation in the Framework of ELI".

Dr. Bedřich Rus introduced the project and presented possible cooperation of the industrial sector during the construction of the centre.

### PRESENTATIONS OF ELI BEAMLINES ABROAD



In the framework of the international communication activities of the ELI Beamlines project, presentations were held in Berlin, London, Paris and Rome. These presentations aimed at meeting and informing representatives of local scientific institutions and companies and they were organized in cooperation with the Ministry of Education, Youth and Sports and the Ministry of Foreign Affairs.



## SIGNATURE OF MEMORANDUM OF UNDERSTANDING



On Friday 16 April, the three countries that will host ELI, the Czech Republic, Hungary and Romania, signed a Memorandum of Understanding on the future implementation and operation of the project. It is expected that other countries, whose experts will participate in realization of the ELI project, will join the Delivery Consortium established and defined by this document. This new structure should organize the transition to the future European Consortium in charge of operating the project.

## FIRST ELI BEAMLINES INTERNATIONAL SCIENTIFIC WORKSHOP IN PRAGUE



The first international scientific workshop on ELI Beamlines took place 26-27 April in hotel Diplomat. This workshop "Scientific Challenges on the future ELI Beamlines Facility" focused on the prestigious research programs and new-generation technologies that will be investigated within the ELI Beamlines laser center in the Czech Republic. On the same occasion, the International Scientific Advisory Committee of the ELI Beamlines project was established.

Approximately 80 invited Czech and international experts participated in the workshop. Their expertise and experience will be certainly essential to the successful realization of the project. A press conference was also organized during this event.

## PRESS CONFERENCE AT THE SEAT OF THE CENTRAL BOHEMIA REGION



Official support of the Central Bohemia Region to top research projects ELI and BIOCEV was expressed by the governor of the Region Mr. David Rath on 3 May 2010 during a press conference. Both projects will be realized in the Central Bohemia Region. The ELI project was represented by the Director of the Institute of Physics Mr. Jan Řídký.

## PROJECT ELI BEAMLINES AWAITING FINAL DECISION

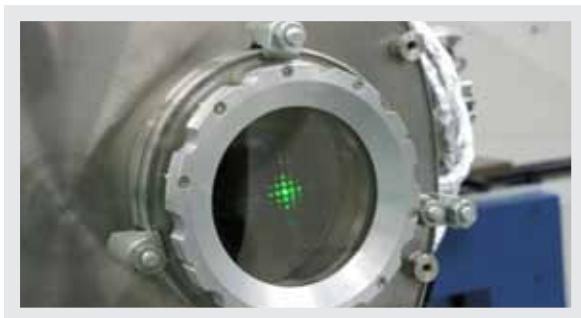

The ELI project was sent to the European Commission (Directorate General for Regional Policy) by the Ministry of Education, Youth and Sports on 30 June 2010. It will be evaluated and a final decision is expected by the end of 2010.

For more information on the project please go to: [www.eli-beams.eu](http://www.eli-beams.eu).

Institute of Physics AS CR, v.v.i.  
Na Slovance 2, 182 21 Prague 8  
tel. +420 266 052 207  
email: [eli-cz@fzu.cz](mailto:eli-cz@fzu.cz)